

A2 INSTALLATION DRAWING

If this document is printed in hardcopy, it is for information use only and therefore is not subject to updating controls. Always refer to viewer for latest issue.

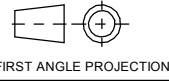

THIS DRAWING IS CONFIDENTIAL AND IS SUPPLIED ON THE EXPRESS CONDITION THAT IT SHALL NOT BE LOANED OR COPIED OR DISCLOSED TO ANY OTHER PERSON OR USED FOR ANY OTHER PURPOSE WITHOUT THE WRITTEN CONSENT OF AP RACING LTD.



AP Racing
 Wheler Road
 Coventry
 CV3 4LB
 Tel: +44 024 7663 9595
 Fax: +44 024 7663 9559
 e-mail: sales@apracing.co.uk
 Web site: http://www.apracing.com

PART NUMBER
 CP3550-14

GENERAL DESCRIPTION
 PROPORTIONING VALVES ARE SPECIALLY DESIGNED FOR USE IN COMPETITION VEHICLES WHERE IT IS DESIRED TO REDUCE THE HYDRAULIC LINE PRESSURE AND THEREFORE BRAKING EFFORT OF USUALLY REAR BRAKES TO COMPENSATE FOR VARYING ROAD/TRACK CONDITIONS OR VEHICLE HANDLING CHARACTERISTICS.

THIS PROPORTIONING VALVE WITH IT'S ADJUSTMENT SCREW CAP OFFERS INFINITE ADJUSTMENT WITHIN THE LIMITS OF NORMAL BRAKE OPERATION.

THIS VALVE HAS A NOMINAL RATIO OF 0.325.

WEIGHT
 180g (APPROX)

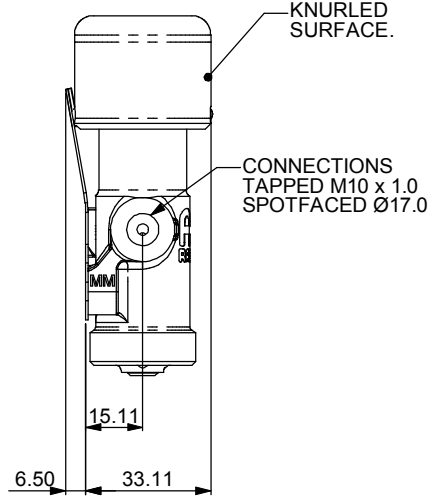
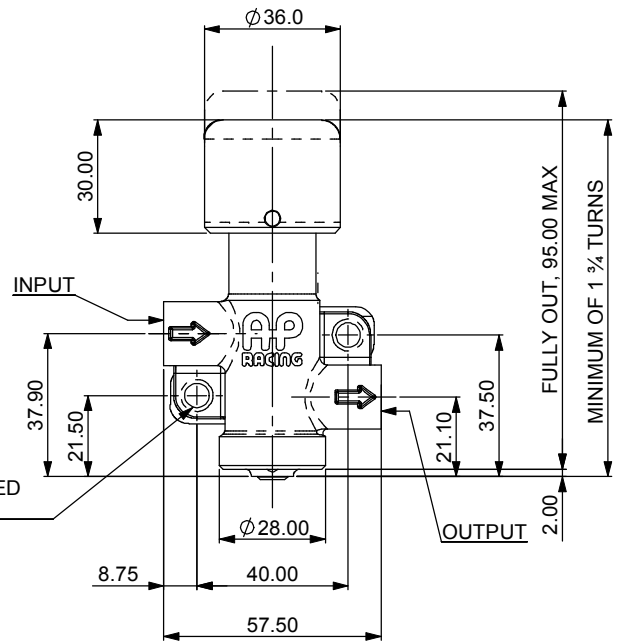

2 OFF M6 CLEARANCE HOLES COUNTERBORED Ø11.0 TO DEPTH 7.0

AP RACING TECHNICAL SECTION WILL BE PLEASED TO ADVISE ON THE MOST SUITABLE EQUIPMENT FOR ANY PARTICULAR APPLICATION AND CAN PROVIDE MORE DETAILED TECHNICAL INFORMATION IF REQUIRED.

DUE TO INTERNAL ADJUSTMENT SET BY AP RACING, **DO NOT** STRIP THIS ASSY. **DO NOT** ATTEMPT ANY MODIFICATIONS OF THIS VALVE.

CP3550-14, Screw Type Proportioning Valve, Performance Chart

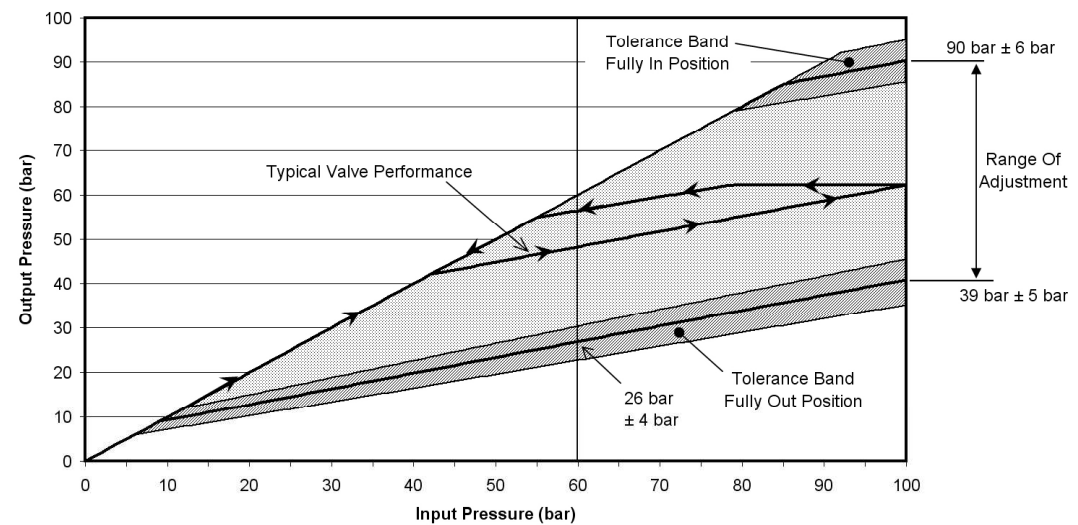

GRAPH NOTES:
 HYSTERESIS IS GREATER WITH THE CAP IN THE FULLY OUT POSITION AND IS AFFECTED BY THE REAR FLUID DISPLACEMENT.

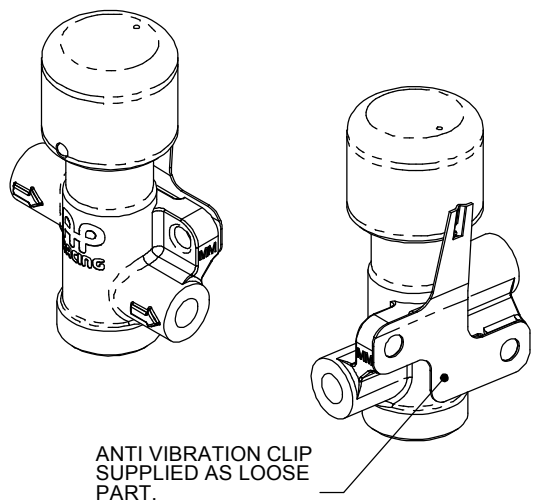

Issue No.		Date & No.		Alterations Particulars		Zone	Initials
1		29/06/2009	B5626	FIRST ISSUE		#	CDA

SCALE 1:1	SHEET 1 OF 1
DRAWN	Chris Arrowsmith
APPROVED	
DERIVED FROM	
TITLE PROPORTIONING VALVE INSTALLATION DRAWING	
DRG NO.	CP3550-14CD