



## FITTING INSTRUCTIONS FOR PFF85-203

Thank you for purchasing one of the advanced range of POWERFLEX polyurethane suspension bush kits.

With PFF85-203 Golf front wishbone, rear bushes these may need to be pressed into position. This can be done between the jaws of a vice.

Once old bushes have been removed (this may require the use of a press, or put a hacksaw blade through the void in the bush and cut the outer sleeve) always clean faces and bores to ensure correct fit.

This kit includes a thin sleeve. This needs to be fitted into the POWERFLEX bush after the arm is fitted onto the car but before the mounting bolt is re-fitted.

Should you experience any technical difficulties in any way please contact our technical Hotline.

(+44) 01895 460033



## FITTING INSTRUCTIONS FOR PFF85-203

Thank you for purchasing one of the advanced range of POWERFLEX polyurethane suspension bush kits

With PFF85-203 Golf front wishbone, rear bushes these may need to be pressed into position. This can be done between the jaws of a vice.

Once old bushes have been removed (this may require the use of a press, or put a hacksaw blade through the void in the bush and cut the outer sleeve) always clean faces and bores to ensure correct fit.

This kit includes a thin sleeve. This needs to be fitted into the POWERFLEX bush after the arm is fitted onto the car but before the mounting bolt is re-fitted.

Should you experience any technical difficulties in any way please contact our technical Hotline.

(+44) 01895 460033 (+44) 01895 460033

### PFF85-203

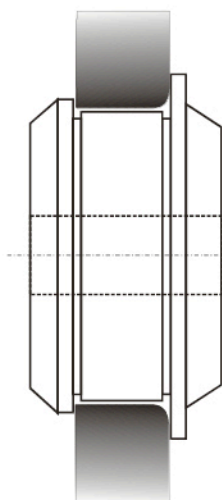

*Ensure large Diameter washer is located to the radiused side of the arm*

### PFF85-203

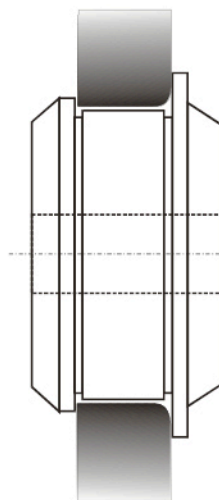

*Ensure large Diameter washer is located to the radiused side of the arm*