



PART NUMBER
PFR3-1131

DESCRIPTION
REAR DIFF FRONT MOUNTING BUSH

INSTALLATION GUIDE

Contents (parts per pack):

2 x PFR3-1131 Bushes 1 x PTFE/Silicone Grease
1 x Stainless Steel Sleeve 1 x Anodised Aluminium Outer Shell

Please read the complete fitting instructions and check package components before fitment. These fitting instructions are to be used as a guide and in conjunction with workshop manual.

It is recommended that:

- all work to be carried out by a licensed technician;*
- all safety precautions adhered to;*
- wheel alignment to be checked and adjusted as required after any suspension work.*
- All fasteners must be tensioned to manufacturer's torque settings.*

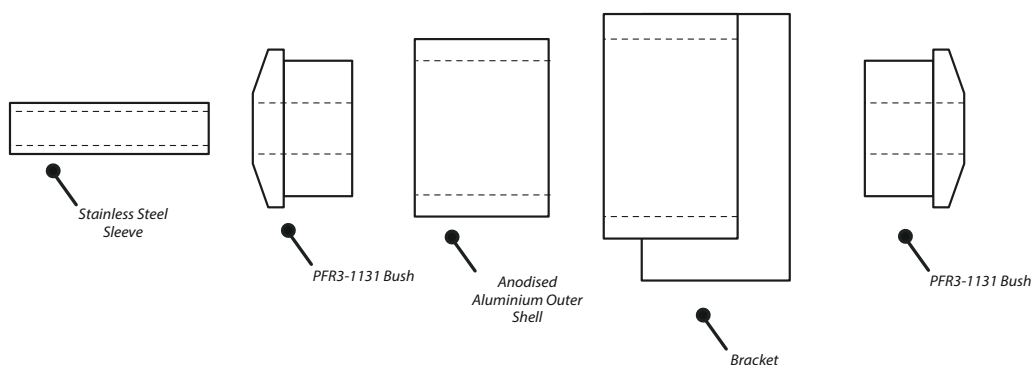

Figure 1

Fitting Instructions:

1. Remove the original bush and clean away any dirt and corrosion.
2. File away any sharp edges using a rounded file.
3. Using a workshop press or a vice, insert the outer shell into the vacant hole until it sits flush.
4. Insert the PFR3-1131 bushes into each end of the outer shell, so they both sit flush.
5. Apply some of the supplied grease to the bore of the bushes and insert the Stainless Steel Sleeve, until it sits flush within the bore.
6. Refit the bracket to the subframe, remembering to tension all hardware to manufacturers recommended torque settings.