

# POWERFLEX®

**PART NUMBER**  
**PFR5-1921**

**DESCRIPTION**  
**REAR SUBFRAME REAR BUSH INSERT**

## INSTALLATION GUIDE

### Contents (parts per pack):

2 x Polyurethane A Bushes    1 x PTFE/Silicone Grease  
 2 x Polyurethane B Bushes

*Please read the complete fitting instructions and check package components before fitment. These fitting instructions are to be used as a guide and in conjunction with workshop manual. It is recommended that:*

- all work to be carried out by a licensed technician;
- all safety precautions adhered to;
- wheel alignment to be checked and adjusted as required after any suspension work.
- All fasteners must be tensioned to manufacturer's torque settings.



Top

### Fitting Instructions:

1. Support the rear subframe and loosen the bolts. Remove the front mount bolts completely to lower the subframe to gain access.
2. Remove and flash lines from the voids in the original bush and clean any dirt and corrosion.
3. Fit part B polyurethane insert into the top side void on the subframe bush, as shown in Figure 1.
4. Fit part A polyurethane insert into the bottom side void on the subframe bush, as shown in Figure 1.
5. Place the original washer flush against the polyurethane part A's bottom face.
6. Tension all hardware to manufacturers recommended torque settings.

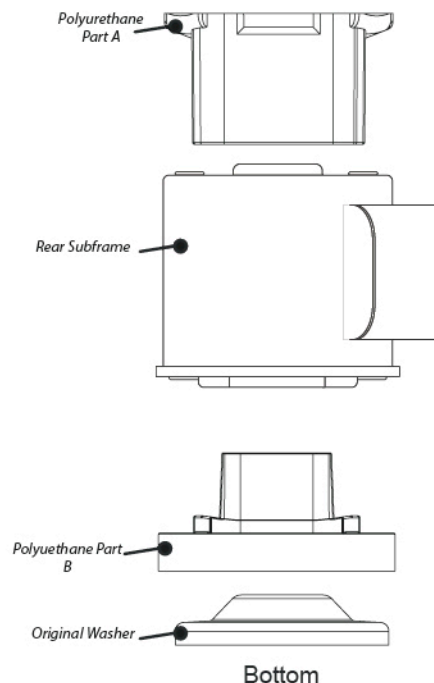

Figure 1